

— WEEKLY —
INVENTORY
HOME LIST

SAVE UP TO
\$10,000*
IN CLOSING COSTS
ON THIS
INVENTORY HOME

EDWARDS CREEK ESTATES



FOR SALE: The Fitzgerald II C on lot 16
Address: 14221 Lons Place, Jacksonville FL 32226

- 2,827 sq. ft.
- 4 bedrooms, 3 bathrooms and a study
- 2-car garage + large 10' x 20' storage area
- 1 acre homesite
- Luxurious features such as a gourmet kitchen, 10+ ft. ceilings, plank-tile flooring, quartz countertops in the kitchen & more!
- NO CDD fees
- Quiet, serene location

PRICED AT \$699,500

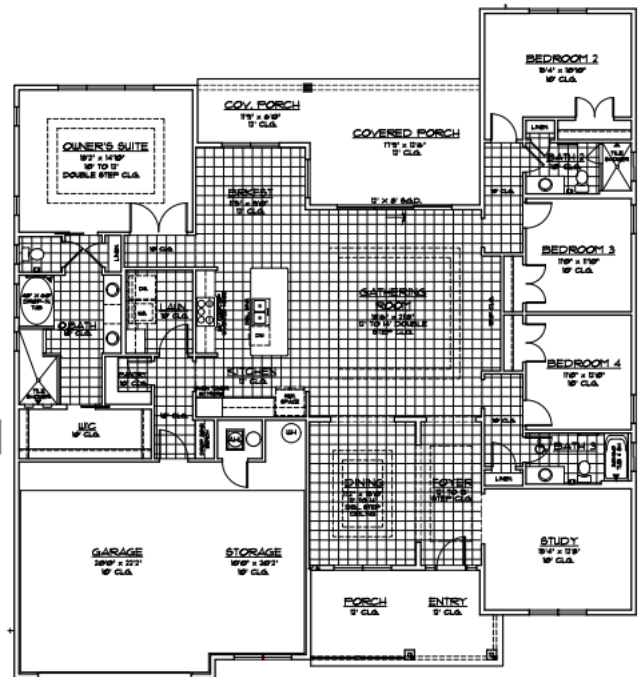

Located in Duval County on Boney Road
with beautiful 1-acre wooded & waterfront
homesites available

CONTACT:
Lauren Becerra (904) 624-6369 lbecerra@sedanewhomes.com



SEDA
NEW HOMES



HONORED TO BE VOTED
**BEST LOCAL
HOME BUILDER**
FOR A 6TH YEAR IN A ROW!
2016 • 2017 • 2018 • 2019 • 2020 • 2021

SEDA Construction Company-CGC020880 *See agent for details- Special applies to full priced contracts written between 3/16/23-3/29/23 only on the home indicated above and must close within 30 days. In Edwards Creek Estates SEDA pays up to \$10,000 toward total closing costs with SEDA approved lender. This offer is for a limited time only & cannot be combined with any other specials. Price & availability subject to change without notice. Prices listed are good for 5 days. Renderings are for conceptional purposes only & may not be the actual color/options of the house. Dated 3/15/23



www.sedanewhomes.com